

## 49003B Door Closer

Not to scale

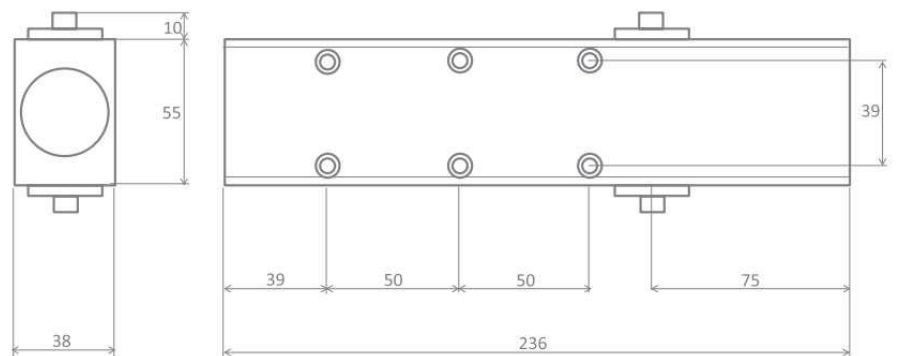

### Overview

#### 49003B

adjustable power 2-5 back check door closer

- Adjustable closing speed
- Adjustable latch action
- Power size EN2-4 adjustable power on spring strength
- CE marked
- Available in Silver or Satin stainless steel

### Maintenance

- Maintenance must be performed by specialist ensuring maintenance and servicing are in align with regulations. Check that the arm connecting to the body of the closer is tight and not loose.
- Check the door operation by releasing the door from fully open position, ensure it closes fully into the frame and that the latch, if fitted, slides fully into the strike plate
- Repeat check, by releasing door from different opening angles. If door closure speed needs adjusting, a specialist can adjust the speed value, power controls etc.

### Certification

Certifire Approved - CF689

### Performance Test

Tested to 200,000 cycles

Included in successful fire test to EN1634

Suitable for use on timber fire doors of up to 120 minutes fire resistance

### Please note:

Aspex reserves the right to change specification without notice.